

# L'avancée technologique...

## D'ARTAGNAN & ATHOS

2500W AND 1200W HMI ZOOM PROFILES.

DIGITAL CONTROL OF DIMMING AND IGNITION:  
DMX AND 0/+10V.



**ATHOS**  
1200W G38

910SNX 9/26°  
914SNX 18/38°  
913SNX 30/53°

**D'ARTAGNAN**  
2500W G38

930SNX 9/26°  
934SNX 18/38°  
933SNX 30/53°

Route de Beaumont F 60530 Fresnoy - en - Thelle. tél.: 33 (0)3.44.26.51.89 fax: 33 (0)3.44.26.90.79

# La lumière, l'art de l'ombre.

 **robert juliat**

Distributed by :

# SNX HMI RANGE - The features that make the difference...

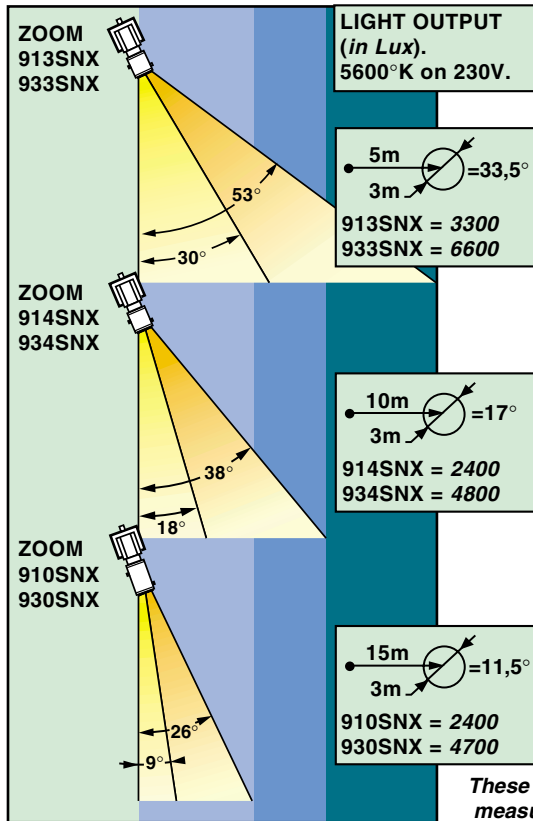

934SNX rear view.



These figures are a guide for comparison between ROBERT JULIAT products. The measurements were taken from the centre of a sharp focus beam without hot spot.

942.150B Robert Juliat reserve the right to change or alter any of the items detailed in this catalogue, to improve manufacturing techniques without prior notice.

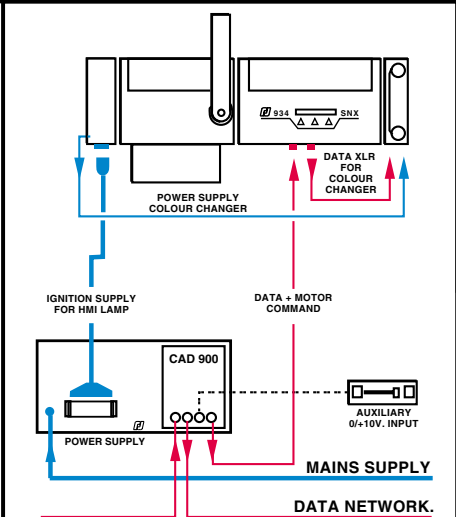
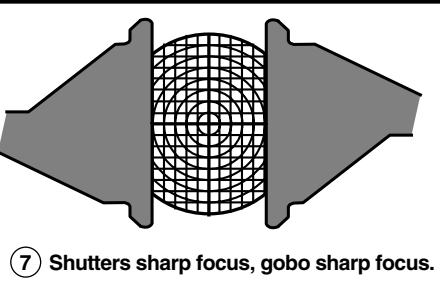
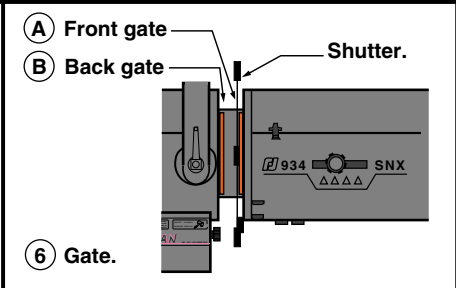
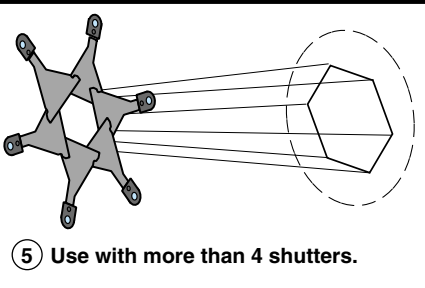
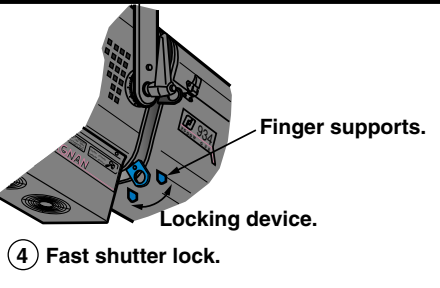
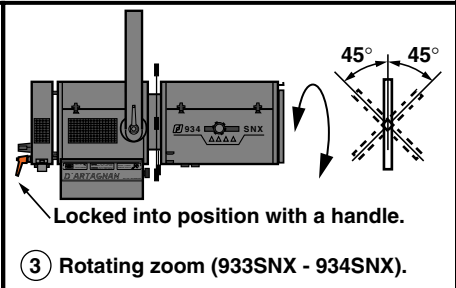
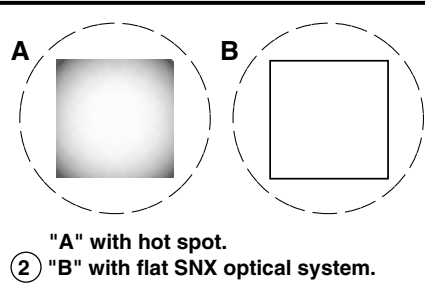
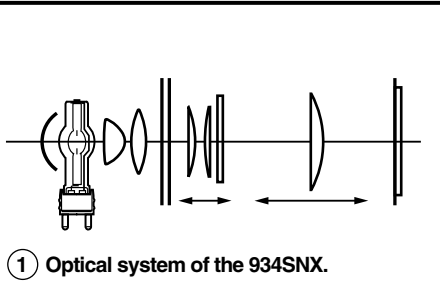

## **SNX RANGE - The details that make the difference...**

### **OPTICAL SYSTEM.**

- ROBERT JULIAT use a double condenser optical system (1). This gives a flat powerful light across the full beam width, without the hot spot and associated tail off towards the edge of the beam (2).
- The high quality optical system uses very pure tempered lenses with photographic coating to improve light transmission and cut down on reflection.
- These lenses are mounted in soft mica clips on stainless steel holders.

### **GATE.**

- 90° rotating zoom incorporates both the shutter and gobo gates (except for 910SNX & 930SNX). This is locked into position by a handle on the back of the lamp housing (3). The lamp housing remains static as its rotation would cause the bulb to burn at a bad angle, shortening life.
- The new original shutter gate design has a shutter lock and finger supports which allow quick and easy locking and unlocking without moving the lamp or shutter position (4).
- Up to 8 shutters can be used (two in each gate) allowing far greater design possibilities (5). The shutters are made from heavy duty stainless steel, sanded and tempered to a black matt finish reducing reflection.
- The gobo gate has two slots (6).
  - Slot "A" is close to the shutters allowing both shutters and gobo to be sharp (7).
  - Slot "B" allows focus control between the shutters and or a gobo in slot "A". A 3D effect is possible by balancing between two gobos.The slots have a sliding pressure bar that provides enough tension to hold the gobo or iris but still allowing easy one handed operation.
- All the accessories are standard across the full SX and SNX range.

### **LAMP HOUSING.**

- The lamp housing is fan cooled.
- Easy access is provided to change the bulb while maintaining high structural integrity of the unit. Access to the 900 SNX is through the top of the lamp housing.
- The condenser lens unit is fitted into a groove by a screw clasp, easily removable for cleaning.
- The optical system is factory set and requires no realignment. Condenser optical systems rely on precise alignment of mirror, lamp and condenser lenses which are locked solid by the lamp design ensuring the same high performance between different units using the same bulb type, make matching simple.

- Heavy duty trunion arm with conical locking handle with tilt measurements. Wider mounting, allowing access to the bulb in any position.

### **ZOOM.**

- The beam adjustments slides are on each side of the zoom enclosure. This enables simultaneous movement. The left side controls size while the right controls focus.
- Internal slot between lenses for soft and dichroic glass (120 x 120mm).
- Three zooms offered in both power ratings. The largest zoom is 30/53° which gives 1 meter beam size for 1 meter throw at 53°. This model still retains high beam precision even at the largest size.
- Mains and Data output for DMX colour changer.

### **POWER SUPPLY.**

- Instant and silent restrike ballast.
- Main double pole automatic breaker.
- Mains checklight.
- Service 10A socket with breaker.
- 3m. lamp cable Harting standard (through all the range).
- 2,5 m. power cable with 32A CEE plug (2500W) - 16A N/F SHUKO plug (1200W).
- 3 Voltages/frequency : 230V-50Hz, 245V-50Hz and 208V-60Hz, terminal selector inside ballast.
- For use on direct mains only (not on a dimmer output).

### **THE CAD 900 CONTROL SYSTEM. (9)**

- CAD 900 is a complete control system for HMI sources, controlling a diaphragm inside an HMI profile and the ignition (ON/OFF) of the lamp.
- CAD 900 automatically recognizes a digital signal in DMX or AVAB standard.
- CAD 900 also recognizes analogue input 0/+10V (8). A local control is also provided. The output signal will be the highest level of the different inputs (highest takes precedence).
- CAD 900 is fully user configurable and shows user information through a backlit LCD display (2 lines, 20 characters).
  - For example: Channel number for lamp ignition.
  - Channel number for diaphragm.
  - Lamp's ignition time.
  - Protocol (name and length of the frame).
  - Local control and stage value.
  - DATA Booster on or off.
  - Choice of languages, etc...

### **DESIGN.**

- All working parts readily accessible, allowing easy maintenance.
- Spare parts lists are included with all profiles.
- A thin discreet rose line showing text and design signatures.
- Delivered in two strong cardboard cases.

# SNX HMI RANGE - The accessories that make the difference...

## INCLUDED ACCESSORIES.

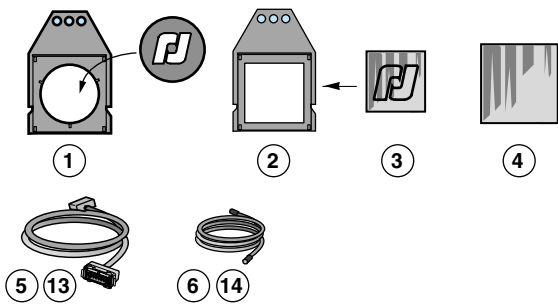

- ① SGCX "A" size metal gobo holder.
- ② SVX 84 84 x 84mm glass gobo holder.
- ③ VD 84 84 x 84mm frosted glass (gate).
- ④ VD 120 120 x 120mm frosted glass (blurred).
- ⑤ A2 1616/3 3m lamp cable.
- ⑥ C1 XLR7/R3 3m shutter cable.

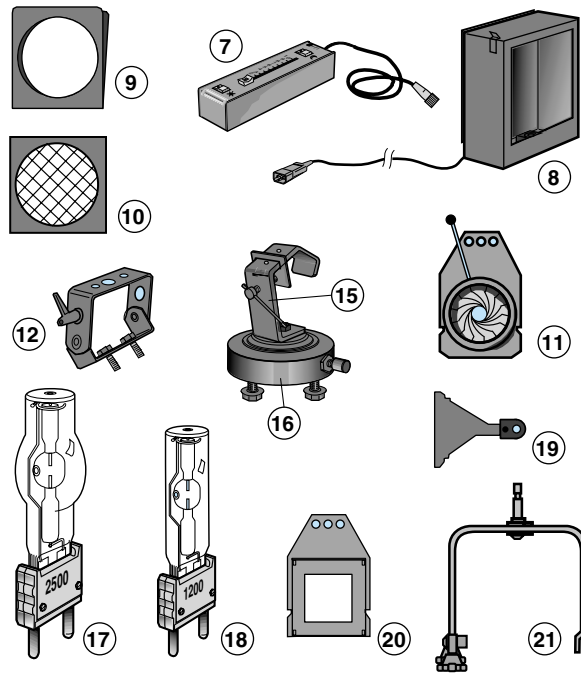

## ACCESSORIES ON OPTION.

- ⑦ P1 F2 XLR4 Local control box 0/+10V. (Ignition and dimming).
- ⑧ RV 934 Cooled filter holder for 933 or 934 models.
- ⑨ PF 1000 C 215 x 215mm cardboard filter frame.
- ⑩ G 1000 215 x 215mm metal safety grid.
- ⑪ IWSX 755 Monoplan iris.
- ⑫ MLA Ballast hanging hardware.
- ⑬ A2 1616/10 10m lamp cable.
- ⑭ C1 XLR7/R10 10m shutter cable.
- ⑮ 877 Strong steel clamp for Ø50mm bar.
- ⑯ 885 Special soft hanging head.
- ⑰ MSR 2500 G 38 HMI/MSR bulb 2500W. 5600°K.
- ⑱ MSR 1200 G 38 HMI/MSR bulb 1200W. 5600°K.
- ⑲ D8 Spare shutter.
- ⑳ SVX 75 75 x 75mm glass gobo holder (gate).
- ㉑ Pole operated yoke.

## TECHNICAL DATA

PROFILES : 910SNX - 930SNX.	STANDARD	OPTION		910SNX	930SNX																																																																											
	<p>Short yoke fitted on the zoom.</p>	<p>Long yoke for over-head use, fitted on the lamp housing.</p>		<table border="1"> <thead> <tr> <th></th> <th>9°</th> <th>26°</th> <th></th> <th></th> </tr> <tr> <th>→</th> <th>Ø</th> <th>LUX</th> <th>Ø</th> <th>LUX</th> </tr> </thead> <tbody> <tr> <td>15 m</td> <td>2,36</td> <td>3920</td> <td>6,93</td> <td>456</td> </tr> <tr> <td>20 m</td> <td>3,15</td> <td>2200</td> <td>9,23</td> <td>256</td> </tr> <tr> <td>25 m</td> <td>3,94</td> <td>1410</td> <td>11,54</td> <td>164</td> </tr> <tr> <td>30 m</td> <td>4,72</td> <td>981</td> <td>13,85</td> <td>114</td> </tr> <tr> <td>35 m</td> <td>5,50</td> <td>720</td> <td>16,15</td> <td>84</td> </tr> </tbody> </table>		9°	26°			→	Ø	LUX	Ø	LUX	15 m	2,36	3920	6,93	456	20 m	3,15	2200	9,23	256	25 m	3,94	1410	11,54	164	30 m	4,72	981	13,85	114	35 m	5,50	720	16,15	84	<table border="1"> <thead> <tr> <th></th> <th>9°</th> <th>26°</th> <th></th> <th></th> </tr> <tr> <th>→</th> <th>Ø</th> <th>LUX</th> <th>Ø</th> <th>LUX</th> </tr> </thead> <tbody> <tr> <td>20 m</td> <td>3,15</td> <td>4170</td> <td>9,23</td> <td>485</td> </tr> <tr> <td>25 m</td> <td>3,95</td> <td>2670</td> <td>11,54</td> <td>310</td> </tr> <tr> <td>30 m</td> <td>4,70</td> <td>1860</td> <td>13,85</td> <td>215</td> </tr> <tr> <td>35 m</td> <td>5,50</td> <td>1365</td> <td>16,15</td> <td>160</td> </tr> <tr> <td>40 m</td> <td>6,30</td> <td>1045</td> <td>18,45</td> <td>121</td> </tr> <tr> <td>45 m</td> <td>7,05</td> <td>825</td> <td>20,75</td> <td>96</td> </tr> </tbody> </table>		9°	26°			→	Ø	LUX	Ø	LUX	20 m	3,15	4170	9,23	485	25 m	3,95	2670	11,54	310	30 m	4,70	1860	13,85	215	35 m	5,50	1365	16,15	160	40 m	6,30	1045	18,45	121	45 m	7,05	825	20,75	96
	9°	26°																																																																														
→	Ø	LUX	Ø	LUX																																																																												
15 m	2,36	3920	6,93	456																																																																												
20 m	3,15	2200	9,23	256																																																																												
25 m	3,94	1410	11,54	164																																																																												
30 m	4,72	981	13,85	114																																																																												
35 m	5,50	720	16,15	84																																																																												
	9°	26°																																																																														
→	Ø	LUX	Ø	LUX																																																																												
20 m	3,15	4170	9,23	485																																																																												
25 m	3,95	2670	11,54	310																																																																												
30 m	4,70	1860	13,85	215																																																																												
35 m	5,50	1365	16,15	160																																																																												
40 m	6,30	1045	18,45	121																																																																												
45 m	7,05	825	20,75	96																																																																												
<b>PROFILES : 914SNX - 934SNX.</b> 	<p>Long yoke, will rotate over lamp housing.</p>	<p>Short yoke, will not rotate over lamp housing.</p>		<table border="1"> <thead> <tr> <th></th> <th>18°</th> <th>38°</th> <th></th> <th></th> </tr> <tr> <th>→</th> <th>Ø</th> <th>LUX</th> <th>Ø</th> <th>LUX</th> </tr> </thead> <tbody> <tr> <td>10 m</td> <td>3,17</td> <td>2060</td> <td>6,90</td> <td>435</td> </tr> <tr> <td>15 m</td> <td>4,75</td> <td>920</td> <td>10,30</td> <td>194</td> </tr> <tr> <td>20 m</td> <td>6,35</td> <td>516</td> <td>13,75</td> <td>109</td> </tr> <tr> <td>25 m</td> <td>7,90</td> <td>330</td> <td>17,20</td> <td>70</td> </tr> </tbody> </table>		18°	38°			→	Ø	LUX	Ø	LUX	10 m	3,17	2060	6,90	435	15 m	4,75	920	10,30	194	20 m	6,35	516	13,75	109	25 m	7,90	330	17,20	70	<table border="1"> <thead> <tr> <th></th> <th>18°</th> <th>38°</th> <th></th> <th></th> </tr> <tr> <th>→</th> <th>Ø</th> <th>LUX</th> <th>Ø</th> <th>LUX</th> </tr> </thead> <tbody> <tr> <td>15 m</td> <td>4,75</td> <td>2000</td> <td>10,30</td> <td>440</td> </tr> <tr> <td>20 m</td> <td>6,35</td> <td>1120</td> <td>13,75</td> <td>237</td> </tr> <tr> <td>25 m</td> <td>7,90</td> <td>720</td> <td>17,20</td> <td>150</td> </tr> <tr> <td>30 m</td> <td>9,50</td> <td>500</td> <td>20,65</td> <td>105</td> </tr> <tr> <td>35 m</td> <td>11,10</td> <td>365</td> <td>24,10</td> <td>77</td> </tr> </tbody> </table>		18°	38°			→	Ø	LUX	Ø	LUX	15 m	4,75	2000	10,30	440	20 m	6,35	1120	13,75	237	25 m	7,90	720	17,20	150	30 m	9,50	500	20,65	105	35 m	11,10	365	24,10	77										
	18°	38°																																																																														
→	Ø	LUX	Ø	LUX																																																																												
10 m	3,17	2060	6,90	435																																																																												
15 m	4,75	920	10,30	194																																																																												
20 m	6,35	516	13,75	109																																																																												
25 m	7,90	330	17,20	70																																																																												
	18°	38°																																																																														
→	Ø	LUX	Ø	LUX																																																																												
15 m	4,75	2000	10,30	440																																																																												
20 m	6,35	1120	13,75	237																																																																												
25 m	7,90	720	17,20	150																																																																												
30 m	9,50	500	20,65	105																																																																												
35 m	11,10	365	24,10	77																																																																												
<b>PROFILES : 913SNX - 933SNX.</b> 	<p>Long yoke, will rotate over lamp housing.</p>	<p>Short yoke, will not rotate over lamp housing.</p>		<table border="1"> <thead> <tr> <th></th> <th>30°</th> <th>53°</th> <th></th> <th></th> </tr> <tr> <th>→</th> <th>Ø</th> <th>LUX</th> <th>Ø</th> <th>LUX</th> </tr> </thead> <tbody> <tr> <td>5 m</td> <td>2,70</td> <td>4140</td> <td>5</td> <td>1200</td> </tr> <tr> <td>10 m</td> <td>5,40</td> <td>1030</td> <td>10</td> <td>300</td> </tr> <tr> <td>15 m</td> <td>8</td> <td>460</td> <td>15</td> <td>133</td> </tr> <tr> <td>20 m</td> <td>10,70</td> <td>260</td> <td>20</td> <td>75</td> </tr> </tbody> </table>		30°	53°			→	Ø	LUX	Ø	LUX	5 m	2,70	4140	5	1200	10 m	5,40	1030	10	300	15 m	8	460	15	133	20 m	10,70	260	20	75	<table border="1"> <thead> <tr> <th></th> <th>30°</th> <th>53°</th> <th></th> <th></th> </tr> <tr> <th>→</th> <th>Ø</th> <th>LUX</th> <th>Ø</th> <th>LUX</th> </tr> </thead> <tbody> <tr> <td>5 m</td> <td>2,70</td> <td>8500</td> <td>5</td> <td>2460</td> </tr> <tr> <td>10 m</td> <td>5,40</td> <td>2130</td> <td>10</td> <td>615</td> </tr> <tr> <td>15 m</td> <td>8</td> <td>950</td> <td>15</td> <td>275</td> </tr> <tr> <td>20 m</td> <td>10,70</td> <td>530</td> <td>20</td> <td>154</td> </tr> <tr> <td>25 m</td> <td>13,40</td> <td>340</td> <td>25</td> <td>100</td> </tr> </tbody> </table>		30°	53°			→	Ø	LUX	Ø	LUX	5 m	2,70	8500	5	2460	10 m	5,40	2130	10	615	15 m	8	950	15	275	20 m	10,70	530	20	154	25 m	13,40	340	25	100										
	30°	53°																																																																														
→	Ø	LUX	Ø	LUX																																																																												
5 m	2,70	4140	5	1200																																																																												
10 m	5,40	1030	10	300																																																																												
15 m	8	460	15	133																																																																												
20 m	10,70	260	20	75																																																																												
	30°	53°																																																																														
→	Ø	LUX	Ø	LUX																																																																												
5 m	2,70	8500	5	2460																																																																												
10 m	5,40	2130	10	615																																																																												
15 m	8	950	15	275																																																																												
20 m	10,70	530	20	154																																																																												
25 m	13,40	340	25	100																																																																												
<b>HMI 1200W &amp; 2500W POWER SUPPLY.</b> 	<p>Lamp cable</p> <p>L = 3m. Net weight = 3Kg.</p> <p>CAD900/Shutter cable</p> <p>L = 3m. Net weight = 0,280Kg.</p>	<p>Lamp cable</p> <p>L = 10m. Net weight = 10Kg.</p> <p>CAD900/Shutter cable</p> <p>L = 10m. Net weight = 0,940Kg.</p>	<table border="1"> <thead> <tr> <th rowspan="2"></th> <th colspan="3">PROFILES</th> <th rowspan="2"></th> <th colspan="3">POWER SUPPLY + CABLES</th> </tr> <tr> <th></th> <th></th> <th></th> <th></th> <th></th> <th></th> </tr> </thead> <tbody> <tr> <td>910 - 930 SNX</td> <td>33</td> <td>43</td> <td>0,28m<sup>3</sup> (0,50x0,48x1,16)</td> <td>1200W.</td> <td>28</td> <td>38</td> <td>0,12m<sup>3</sup> (0,40x0,44x0,73)</td> </tr> <tr> <td>914 - 934 SNX</td> <td>30</td> <td>38</td> <td>0,23m<sup>3</sup> (0,50x0,48x0,97)</td> <td>2500W.</td> <td>33</td> <td>43</td> <td>0,12m<sup>3</sup> (0,40x0,44x0,73)</td> </tr> <tr> <td>913 - 933 SNX</td> <td>28</td> <td>35</td> <td>0,23m<sup>3</sup> (0,50x0,48x0,97)</td> <td></td> <td></td> <td></td> <td></td> </tr> </tbody> </table>		PROFILES				POWER SUPPLY + CABLES									910 - 930 SNX	33	43	0,28m <sup>3</sup> (0,50x0,48x1,16)	1200W.	28	38	0,12m <sup>3</sup> (0,40x0,44x0,73)	914 - 934 SNX	30	38	0,23m <sup>3</sup> (0,50x0,48x0,97)	2500W.	33	43	0,12m <sup>3</sup> (0,40x0,44x0,73)	913 - 933 SNX	28	35	0,23m <sup>3</sup> (0,50x0,48x0,97)					<p><i>Lux.±5% for all measurements.</i></p>																																						
	PROFILES					POWER SUPPLY + CABLES																																																																										
910 - 930 SNX	33	43	0,28m <sup>3</sup> (0,50x0,48x1,16)	1200W.	28	38	0,12m <sup>3</sup> (0,40x0,44x0,73)																																																																									
914 - 934 SNX	30	38	0,23m <sup>3</sup> (0,50x0,48x0,97)	2500W.	33	43	0,12m <sup>3</sup> (0,40x0,44x0,73)																																																																									
913 - 933 SNX	28	35	0,23m <sup>3</sup> (0,50x0,48x0,97)																																																																													

942.152B Robert Juliat reserve the right to change or alter any of the items detailed in this catalogue, to improve manufacturing techniques without prior notice.